

Early entries for Certifications and Trial close 6:00 PM, Wednesday, May 7, 2008, at 3705 So. 257<sup>th</sup> Street, Kent, WA 98032-5668  
Day-of-Trial entries close 8:45 AM, Saturday, May 10, 2008 at the Secretary's table, Argus Ranch



EVERGREEN BASENJI CLUB

**ASFA REGION 1 LURE FIELD TRIAL**  
**Saturday, May 10, 2008**

**Argus Ranch, 35612 212th Way SE, Auburn WA 98092**  
**Cell Phone Number on the field: (253) 334-4218**

**Early Entry Fees**

FIRST HOUND..... \$18.00  
SECOND HOUND (same owner) ..... \$16.00  
ANY ADDITIONAL HOUND (same owner) ..... \$14.00

**Day-of-Trial ..... \$25.00/ENTRY**

**Certifications ..... \$10.00/ENTRY**

**OFFERED ONLY ON SATURDAY, BEFORE THE TRIAL, BY EARLY ENTRY ONLY**

(Please use the *Evergreen Basenji Club Certification Early Entry Form* supplied in this premium.)

**LIMITED TO 10 HOUNDS, SO GET YOUR ENTRY FORM IN EARLY!**

Owners of certifying hounds must supply a bye-dog to run with their hound.

Permission has been granted by the American Sighthound Field Association for holding of this event under American Sighthound Field Association Rules and Regulations  
Denise Como Scheduling Chair

**EVERGREEN BASENJI CLUB**

Judy Lange  
3705 So. 257<sup>th</sup> Street  
Kent, WA 98032-5668

**FIRST CLASS MAIL**

**Directions to the Site:**

**From I-5 or Highway 167:** Take Highway 18 east toward Auburn. Take the Auburn-Black Diamond Exit off to the right. At end of off ramp turn right, then immediately right again onto SE Green Valley Rd. Proceed 7.2 miles to 212<sup>th</sup> Way SE, just beyond a green girder bridge sitting on land. Turn right onto 212<sup>th</sup> Way SE, cross the bridge, and then turn left into Argus Ranch. Follow the signs to the lure field.

**From I-90 east of Issaquah:** Take the Highway 18 exit and proceed west toward Maple Valley and Auburn, crossing over Tiger Mountain Pass. Take the Maple Valley exit. At the end of the exit ramp turn left toward Maple Valley and then turn right onto Highway 169 (Maple Valley-Black Diamond Rd.) heading toward Black Diamond and Enumclaw. Go through Black Diamond and about a mile south of town watch for signs pointing to Flaming Geyser State Park. Turn right (west) onto SE Green Valley Rd. A half mile after passing the entrance to the state park, turn left onto 212<sup>th</sup> Way SE, cross the bridge, and then turn left into Argus Ranch. Follow the signs to the lure field

## EVERGREEN BASENJI CLUB OFFICERS

President .....	Bob Gooderl
Vice President.....	Paul Root
Treasurer.....	Jordan Reed
Recording Secretary .....	James Johannes
Corresponding Secretary .....	Mary Monahan
Board Members .....	Brenda Phillips, Elaine Monzon

## JUDGES AND ASSIGNMENTS

Christie Beetz , PO Box 1371, Hollister, CA.....	All Breeds, Singles, Limited/Provisional
Beth Levine:, PO Box 458, Sultan, WA.....	B,IG, IB, S
Mike Savage, PO Box 141737, Spokane, WA...All breeds except B, IG, IB,S, Singles except B, Limited/Provisional	

## FIELD COMMITTEE

Chairman .....	Debbie Nelson
17102 – 8 <sup>th</sup> Ave Ct. E, Spanaway, WA 98387 (253) 537-7912	
Secretary.....	Judy Lange
3705 So. 257 <sup>th</sup> Street, Kent WA 98032-5668 (253) 852-3781	
Lure Operators.....	Bryan Gregory, Vic Horne

## TRIAL HOURS (BOTH DAYS): 7:00 AM UNTIL COMPLETION

**CERTIFICATIONS (SATURDAY ONLY): NO DAY-OF- TRIAL ENTRIES; ROLL CALL – 8:30 AM**

**TRIAL : DAY-OF-TRIAL ENTRIES CLOSE AT 8:45 AM; ROLL CALL – 9:00 AM**

**ENTRIES WILL NOT BE ACKNOWLEDGED BY MAIL**

**NO PHONE, FAX, OR E-MAIL ENTRIES WILL BE ACCEPTED**

**NO LATE, INCOMPLETE, UNSIGNED, UNPAID OR CONDITIONAL ENTRIES WILL BE ACCEPTED.**

**ELIGIBLE BREEDS AND REGISTRY:** Only purebred Afghan Hounds, Azawakhs, Basenjis, Borzois, Greyhounds, Ibizan Hounds, Irish Wolfhounds, Italian Greyhounds, Pharaoh Hounds, Rhodesian Ridgebacks, Salukis, Scottish Deerhounds, Sloughis, and Whippets may be entered in the regular stakes. Limited and Provisional stake breeds which are listed in each issue of Field Advisory News. All entries in the regular stakes shall be individually registered with the American Kennel Club, the National Greyhound Association, the Federation Cynologique Internationale, an ASFA-recognized foreign or ASFA Board-approved registry, or possess a Critique Registration Number (CRN) from the Society for the Perpetuation of the Desert Bred Saluki (SPDBS). Limited and/or Provisional Stake entries shall be individually registered with the appropriate registry.

**RIBBONS:** First = Blue, Second = Red, Third = Yellow, Fourth = White, NBQ = Green, BOB = Purple/Gold,  
BIF = Red, White, and Blue

**TROPHIES:** Best of Breed and Best in Field.

## ACCOMMODATIONS

Days Inn, 1521 D Street NE, Auburn WA 98002, (253) 939-5950

Val-U Inn, 9 14<sup>th</sup> Ave NE, Auburn WA 98001, (253) 735-9600

## VETERINARIANS ON CALL

Auburn Veterinary Hospital, 718 Auburn Way N, Auburn WA 98002, (253) 833-4510

## FIELD ADVISORY NEWS

Jackie Nivison, Editor, 4 N. Howell Street, Ste 200, Hillsdale, MI 49242, faneditor@asfa.org

Bulk Mail (US residents only): \$36 per year. First Class Mail: \$65 per year.

Foreign: (includes Canada and Mexico) \$55 per year, \$125 First Class ( US funds or Money Order.)

## STAKES OFFERED

**OPEN:** Any eligible sighthound, excluding ASFA Field Champions of Record.

**FIELD CHAMPION:** Any ASFA Field Champion.

**VETERAN:** Any eligible hound whose age is at least six years, except Irish Wolfhounds whose age shall be at least five years, and Whippets and Rhodesian Ridgebacks, whose age shall be at least seven years.

**SINGLES:** Any eligible sighthound including those disqualified to run in other stakes. Points are not awarded. Hounds are not eligible to run in BOB or BIF.

**LIMITED:** Any eligible sighthound of a Limited or Provisional stake breed that has met certification requirements.

**BEST IN FIELD** will be offered.

## GENERAL

1. All entries must be one year of age or older on the day of the trial.
2. Stakes shall be split by public random draw if the entry in any one stake is 20 or more at the time of the draw.
3. In the Trial, all hounds will run twice, in trios if possible, or braces, unless excused, dismissed, or disqualified.
4. Hounds not present at the time of roll call will be scratched. Each entry will be examined at inspection for breed disqualifications, bitches in season, and lame hounds, which will be excused. Entry fees for hounds excused during inspection will be refunded. Spayed or neutered hounds without breed disqualifications may be entered.
5. Battery powered **continuous loop** machines will be used. Lure will consist of white plastic bags. The course will be reversed for the finals and run-offs. Backup equipment will be available.
6. The field committee reserves the right to alter the course plan as required by weather and/or field conditions on the day of the trial.
7. **THE FIELD COMMITTEE RESERVES THE RIGHT TO BAR KNOWN AGGRESSIVE HOUNDS FROM THE TRIAL SITE.**
8. **Certifications will be limited to 10 hounds, offered before the trial only on Saturday and by early entry only.**
9. **THERE WILL BE A \$5.00 FINE ASSESSED FOR ANY LOOSE HOUND NOT TAKING PART IN THE COURSE IN PROGRESS, OR FOR ANYONE NOT PICKING UP AFTER THEIR OWN DOG(S). ALL TRASH, INCLUDING DOG FECES, MUST BE HAULED AWAY BY THE OWNER.**
10. **PLEASE BRING YOUR OWN SHADE AND WATER.**
11. **NO ONE, EXCEPT FIELD COMMITTEE, WILL BE ALLOWED ON THE FIELD WITHOUT EXPRESS PERMISSION OF THE FIELD CHAIRMAN.**
12. Anyone exhibiting unsportsmanlike conduct will be excused from the field for the day.
13. No cigarette smoking permitted on this working farm field.

## COURSE PLANS

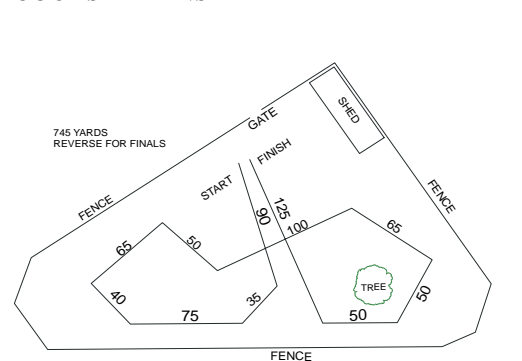

**OFFICIAL AMERICAN SIGHTHOUND FIELD ASSOCIATION ENTRY FORM**

**EVERGREEN BASENJI CLUB**

Saturday, May 10, 2008. Early Entries close Wednesday, May 7, 2007, 6:00 PM  
 Early Entries: \$18 1<sup>st</sup> hound, \$16 2<sup>nd</sup> hound, \$14 additional hound same owner  
 Day-of-Trial Entries: \$25 – close 8:45 AM  
 Make checks payable to EBC. Mail to:  
 Judy Lange, Field Trial Secretary, 3705 So. 257<sup>th</sup> Street, Kent, WA 98032-5668

Fee Paid \_\_\_\_\_ The Field Secretary cannot accept conditional, unsigned, incomplete or unpaid entries; please check your completed entry carefully.

Breed:		Call Name:	
Registered Name of Hound:			
Stake: <input type="checkbox"/> Open <input type="checkbox"/> FCH <input type="checkbox"/> Veteran <input type="checkbox"/> Single <input type="checkbox"/> Limited		Additional Stakes: <input type="checkbox"/> Kennel <input type="checkbox"/> Breeder	
<b>Registration Number:</b> (circle one)			
AKC Reg. # AKC ILP: NGA #: Critique Registration #: Foreign Reg. # & Country: Pending: UKC Reg. #			
<input type="checkbox"/> If possible, please separate my hounds	Date of Birth:	Sex: <input type="checkbox"/> Dog <input type="checkbox"/> Bitch	
Name of actual owner(s):			
Address:		Phone:	
City:		State:	Zip:
E-mail (Optional)		(Optional) Region of Residence:	
<input type="checkbox"/> <b>Check if this is the first ASFA trial for this hound. Attach a Hound Certification or waiver if entered in Open, Veterans, Limited.</b>			
<input type="checkbox"/> <b>Check if this is a first-time entry, a copy of the official Registration of this hound must accompany this entry unless NGA.</b>			
<input type="checkbox"/> Check if any information has changed since the last ASFA trial entry. Regarding _____			
<input type="checkbox"/> Check if this hound has been dismissed within the last 6 trials entered. Must be marked in order to qualify for a "clean" trial requirement.			

I CERTIFY that I am the actual owner of this dog, or that I am the duly authorized agent of the actual owner whose name I have entered above. In consideration of the acceptance of this entry and the opportunity to have this dog judged and to win prize money, ribbons, or trophies, I (we) agree to abide by the rules and regulations of the American Sighthound Field Association in effect at the time of this lure field trial, and by any additional rules and regulations appearing in the premium list for this lure field trial. I (we) agree that the club holding this lure field trial has the right to refuse this entry for cause, which the club shall deem to be sufficient. I (we) agree to hold this club, its members, directors, governors, officers, agents or other functionaries, any employees of the aforementioned parties and the owner(s) of the trial premises or grounds harmless from any claim for loss or injury which may be alleged to have been caused directly or indirectly to any person or thing by the act of this dog while in or upon the lure field trial premises or grounds or near any entrance thereto and I (we) personally assume all responsibility and liability for any such claim, and I (we) further agree to hold the aforementioned parties harmless from any claim loss of this dog by disappearance, theft damage or injury be caused or alleged to be caused by the negligence of the club or any of the aforementioned parties or by the negligence of any person or any other cause or causes. I (we) certify and represent that the dog entered is not a hazard to person or other dogs. This entry is submitted for acceptance of the forgoing representations and agreements

**SIGNATURE** of owner or his agent  
 duly authorized to make this entry \_\_\_\_\_

**OFFICIAL AMERICAN SIGHTHOUND FIELD ASSOCIATION ENTRY FORM**

**EVERGREEN BASENJI CLUB**

Sunday, May 10, 2007. Early Entries close Wednesday, May 7, 2007, 6:00 PM  
 Early Entries: \$18 1<sup>st</sup> hound, \$16 2<sup>nd</sup> hound, \$14 additional hound same owner  
 Day-of-Trial Entries: \$25 – close 8:45 AM  
 Make checks payable to EBC. Mail to:  
 Judy Lange, Field Trial Secretary, 3705 So. 257<sup>th</sup> Street, Kent, WA 98032-5668

Fee Paid \_\_\_\_\_ The Field Secretary cannot accept conditional, unsigned, incomplete or unpaid entries; please check your completed entry carefully.

Breed:		Call Name:	
Registered Name of Hound:			
Stake: <input type="checkbox"/> Open <input type="checkbox"/> FCH <input type="checkbox"/> Veteran <input type="checkbox"/> Single <input type="checkbox"/> Limited		Additional Stakes: <input type="checkbox"/> Kennel <input type="checkbox"/> Breeder	
<b>Registration Number:</b> (circle one)			
AKC Reg. # AKC ILP: NGA #: Critique Registration #: Foreign Reg. # & Country: Pending: UKC Reg. #			
<input type="checkbox"/> If possible, please separate my hounds	Date of Birth:	Sex: <input type="checkbox"/> Dog <input type="checkbox"/> Bitch	
Name of actual owner(s):			
Address:		Phone:	
City:		State:	Zip:
E-mail (Optional)		(Optional) Region of Residence:	
<input type="checkbox"/> <b>Check if this is the first ASFA trial for this hound. Attach a Hound Certification or waiver if entered in Open, Veterans, Limited.</b>			
<input type="checkbox"/> <b>Check if this is a first-time entry, a copy of the official Registration of this hound must accompany this entry unless NGA.</b>			
<input type="checkbox"/> Check if any information has changed since the last ASFA trial entry. Regarding _____			
<input type="checkbox"/> Check if this hound has been dismissed within the last 6 trials entered. Must be marked in order to qualify for a "clean" trial requirement.			

I CERTIFY that I am the actual owner of this dog, or that I am the duly authorized agent of the actual owner whose name I have entered above. In consideration of the acceptance of this entry and the opportunity to have this dog judged and to win prize money, ribbons, or trophies, I (we) agree to abide by the rules and regulations of the American Sighthound Field Association in effect at the time of this lure field trial, and by any additional rules and regulations appearing in the premium list for this lure field trial. I (we) agree that the club holding this lure field trial has the right to refuse this entry for cause, which the club shall deem to be sufficient. I (we) agree to hold this club, its members, directors, governors, officers, agents or other functionaries, any employees of the aforementioned parties and the owner(s) of the trial premises or grounds harmless from any claim for loss or injury which may be alleged to have been caused directly or indirectly to any person or thing by the act of this dog while in or upon the lure field trial premises or grounds or near any entrance thereto and I (we) personally assume all responsibility and liability for any such claim, and I (we) further agree to hold the aforementioned parties harmless from any claim loss of this dog by disappearance, theft damage or injury be caused or alleged to be caused by the negligence of the club or any of the aforementioned parties or by the negligence of any person or any other cause or causes. I (we) certify and represent that the dog entered is not a hazard to person or other dogs. This entry is submitted for acceptance of the forgoing representations and agreements

**SIGNATURE** of owner or his agent  
 duly authorized to make this entry \_\_\_\_\_

**AMERICAN SIGHTHOUND FIELD ASSOCIATION  
HOUND CERTIFICATION**

**Rule effective October 1, 1994: Ch. V, Sec. 4 (a) OPEN STAKE:** *To be eligible to enter the open stake, a hound must have been certified by a licensed judge within the year preceding the closing date for the entry or have previously competed in the Open Stake.* This eligibility requirement also applies to a hound entered in the Limited or Veteran Stake, which has not competed in Open previously. Please complete this portion of this form and attach it to the entry form for the hound's first entry, including an entry for a Fun Trial.

Registered Name of Hound: \_\_\_\_\_

Registration Number: \_\_\_\_\_ Breed: \_\_\_\_\_

Registered Owner's Name: \_\_\_\_\_

I hereby certify that on (date) \_\_\_\_\_, the above named hound completed a lure course of at least 500 yards, running with another hound of the same breed (or another breed with a similar running style). During the course the above named hound showed no inclination to interfere with the other hound. I further certify that I am a licensed judge for the ASFA.

Name of Licensed Judge: \_\_\_\_\_

Signature: \_\_\_\_\_ Date: \_\_\_\_\_

I hereby certify that the hound running in the certification course is the hound identified above and that information provided on this form is true and correct.

Signature: \_\_\_\_\_ Date: \_\_\_\_\_

Owner or Authorized Agent of Hound

This certification form must be attached to the entry form the first time this hound is entered in an open, limited, or veteran stake. Any hound entered in open, limited, or veteran (as a first time entered hound), which has not been certified, shall be declared ineligible by the records coordinator and shall forfeit any points and placements awarded.

**PLEASE RETAIN A COPY FOR YOUR RECORDS.**

**AMERICAN SIGHTHOUND FIELD ASSOCIATION  
HOUND CERTIFICATION WAIVER**

**Waiver of Requirement:** *This requirement will be waived for a hound that has earned a lure coursing or racing title from another recognized organization, if such title requires competition, and if a waiver for such title has been approved by the ASFA, or a CKC Hound Certification Form. If your hound qualifies for a waiver, complete this portion of this form and attach it to your entry form. Proof of waivers must accompany this certification form.*

Registered Name of Hound: \_\_\_\_\_

Registration Number: \_\_\_\_\_ Breed: \_\_\_\_\_

Registered Owner's Name: \_\_\_\_\_

**CKC:** FCH FCHX **CWA:** ARX TRP SRA DPC

**AKC:** FC SC **LGRA:** GRC **NAWRA:** RCH SR

**WRA:** CR WRCH **NOTRA:** ORC OTR SORC SOR

Hound Certification previously submitted.

I hereby certify that the hound identified above has completed the requirements for the title indicated above (or that the required Certification was previously submitted) and that the information provided on this form is true and correct.

Signature: \_\_\_\_\_ Date: \_\_\_\_\_

Owner or Authorized Agent of Hound

**AMERICAN SIGHTHOUND FIELD ASSOCIATION  
HOUND CERTIFICATION**

**Rule effective October 1, 1994: Ch. V, Sec. 4 (a) OPEN STAKE:** *To be eligible to enter the open stake, a hound must have been certified by a licensed judge within the year preceding the closing date for the entry or have previously competed in the Open Stake.* This eligibility requirement also applies to a hound entered in the Limited or Veteran Stake, which has not competed in Open previously. Please complete this portion of this form and attach it to the entry form for the hound's first entry, including an entry for a Fun Trial.

Registered Name of Hound: \_\_\_\_\_

Registration Number: \_\_\_\_\_ Breed: \_\_\_\_\_

Registered Owner's Name: \_\_\_\_\_

I hereby certify that on (date) \_\_\_\_\_, the above named hound completed a lure course of at least 500 yards, running with another hound of the same breed (or another breed with a similar running style). During the course the above named hound showed no inclination to interfere with the other hound. I further certify that I am a licensed judge for the ASFA.

Name of Licensed Judge: \_\_\_\_\_

Signature: \_\_\_\_\_ Date: \_\_\_\_\_

I hereby certify that the hound running in the certification course is the hound identified above and that information provided on this form is true and correct.

Signature: \_\_\_\_\_ Date: \_\_\_\_\_

Owner or Authorized Agent of Hound

This certification form must be attached to the entry form the first time this hound is entered in an open, limited, or veteran stake. Any hound entered in open, limited, or veteran (as a first time entered hound), which has not been certified, shall be declared ineligible by the records coordinator and shall forfeit any points and placements awarded.

**PLEASE RETAIN A COPY FOR YOUR RECORDS.**

**AMERICAN SIGHTHOUND FIELD ASSOCIATION  
HOUND CERTIFICATION WAIVER**

**Waiver of Requirement:** *This requirement will be waived for a hound that has earned a lure coursing or racing title from another recognized organization, if such title requires competition, and if a waiver for such title has been approved by the ASFA, or a CKC Hound Certification Form. If your hound qualifies for a waiver, complete this portion of this form and attach it to your entry form. Proof of waivers must accompany this certification form.*

Registered Name of Hound: \_\_\_\_\_

Registration Number: \_\_\_\_\_ Breed: \_\_\_\_\_

Registered Owner's Name: \_\_\_\_\_

**CKC:** FCH FCHX **CWA:** ARX TRP SRA DPC

**AKC:** FC SC **LGRA:** GRC **NAWRA:** RCH SR

**WRA:** CR WRCH **NOTRA:** ORC OTR SORC SOR

Hound Certification previously submitted.

I hereby certify that the hound identified above has completed the requirements for the title indicated above (or that the required Certification was previously submitted) and that the information provided on this form is true and correct.

Signature: \_\_\_\_\_ Date: \_\_\_\_\_

Owner or Authorized Agent of Hound

**EVERGREEN BASENJI CLUB CERTIFICATION EARLY ENTRY FORM**

**USE THIS EARLY ENTRY FORM FOR HOUND CERTIFICATION RUNS ONLY!**

Other forms are provided for entering your hounds in the ASFA Region 1 Lure Field Trial

*Owners of certifying hounds must supply a bye-dog to run with their hound.*

*Hounds which certify and wish to enter the trial must provide copy of AKC Registration Certificate*



**EVERGREEN BASENJI CLUB**

Saturday, May 10, 2007. Early entries close Wednesday, May 7, 2007, 6:00 PM

Early entries: \$10

Make checks payable to EBC. Mail to:

Judy Lange, Field Trial Secretary  
3705 So. 257<sup>th</sup> Street, Kent. WA 98032-5668

Fee Paid \$ \_\_\_\_\_ The Field Secretary cannot accept conditional, unsigned, incomplete or unpaid entries; please check your completed entry carefully.

Breed		Call Name	
Registered Name			
<b>Registration Number</b> (check one): <input type="checkbox"/> AKC Registration, <input type="checkbox"/> AKC ILP, <input type="checkbox"/> NGA #, <input type="checkbox"/> Critique Registration #, <input type="checkbox"/> Foreign Reg. # & Country, <input type="checkbox"/> Check if Pending			
Date of Birth	Sex <input type="checkbox"/> Dog <input type="checkbox"/> Bitch		
Name of actual owner(s)			
Address		Phone	
City	State	Zip	
E-mail (Optional)		(Optional) Region of Residence	

I CERTIFY that I am the actual owner of this dog, or that I am the duly authorized agent of the actual owner whose name I have entered above. I (we) agree to abide by the rules and regulations of the Evergreen Basenji Club in effect at the time of this lure field trial, and by any additional rules and regulations appearing in the premium list for this lure field trial. I (we) agree that the club holding this lure field trial has the right to refuse this entry for cause, which the club shall deem to be sufficient. I (we) agree to hold this club, its members, directors, governors, officers, agents or other functionaries, any employees of the aforementioned parties and the owner(s) of the trial premises or grounds harmless from any claim for loss or injury which may be alleged to have been caused directly or indirectly to any person or thing by the act of this dog while in or upon the lure field trial premises or grounds or near any entrance thereto and I (we) personally assume all responsibility and liability for any such claim, and I (we) further agree to hold the aforementioned parties harmless from any claim loss of this dog by disappearance, theft damage or injury be caused or alleged to be caused by the negligence of the club or any of the aforementioned parties or by the negligence of any person or any other cause or causes. I (we) certify and represent that the dog entered is not a hazard to person or other dogs. This entry is submitted for acceptance of the forgoing representations and agreements.

**SIGNATURE** of owner or his agent  
duly authorized to make this entry: \_\_\_\_\_

**Please join us for a Potluck on Saturday  
EBC will provide a 40<sup>th</sup> Anniversary Cake  
Please bring any dish of your choice  
other than dessert**

**On Sunday EBC will provide Poor Boy  
Sandwiches  
for a donation.**

**\*\*Please note that there may be no food vendor on the field. However, there are restaurants and fast food available in Auburn, about 15 minutes from the field.**

**\*\*\*Also, please note that parking will be limited due to Agility Trials at the site on both days. Parking in the paddock area will be limited to Field Committee. Limited parking along the fences inside the field. Plan to arrive early for most convenient parking.\*\*\***